

STARHOTELS®
PREMIUM

Michelangelo
ROMA



Michelangelo

ROMA



The essence of Rome

Cosmopolitan style and classic grandeur. Ceaseless energy and timeless allure. In many ways, the Michelangelo epitomizes the contrasts and contradictions that make Roma one of the world's greatest cities. Standing just moments from the Vatican, in the heart of baroque Roma, it's hard to imagine a more central spot. Many of the 179 rooms have views across to St Peter's Basilica. While contemporary in style, the hotel is inspired by the same Italian spirit, personal touch, and attention to detail of its namesake: the grand master of Renaissance art.

Michelangelo

ROMA

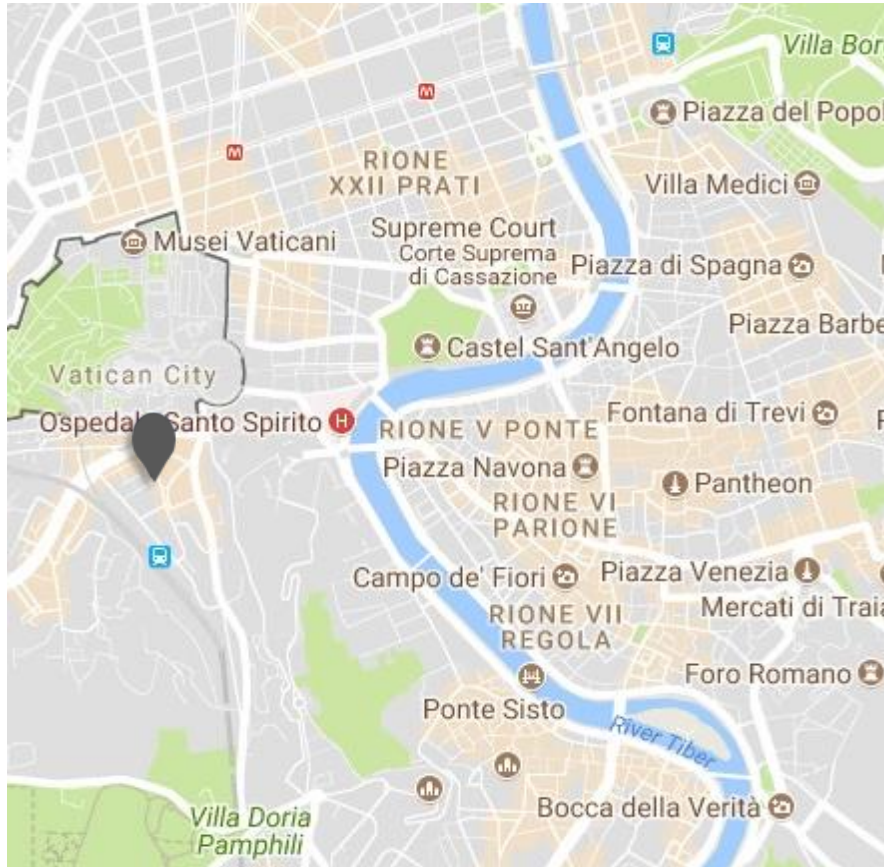

Location

A few steps away from St-Peter's Square, and 15 minutes by taxi to reach the train station and the airport

Distances

Central railway station: Km 6

Highway: Km 10

Airport: Fiumicino Km 30

Via Della Stazione di S. Pietro, 14
00165 Roma - ITALY
T +39 06 398739 F +39 06 632359
michelangelo.rm@starhotels.it
starhotels.com

Michelangelo

ROMA

Restaurant & Bar

Savour the authentic experience of dining in Rome at the Dome Restaurant by Eataly. With its intimate, informal surroundings and menu of classic Roman cuisine – together with international favorites – you needn't venture far to find one of the city's hidden treasures.

The Dome by Eataly Bar is a tranquil and intimate ambience reserved for the hotel's guests.

A perfect place to relax, have a coffee or enjoy a light lunch or cocktails.



Michelangelo

ROMA



179 Rooms

13 Classic
67 Superior
89 Deluxe
4 Junior Suite
6 Suite

179 recently refurbished rooms and suites with interiors of muted tones, tactile fabrics and indulgent touches. Many rooms have a wonderful views across to St Peter's Basilica.



Michelangelo

ROMA



Meetings & Events

Meeting rooms: 2

Capacity (theatre style): 140 max

The Michelangelo hotel provides a prestigious setting for any business meeting and conferences in Rome.

Facilities include two modular meeting rooms for up to 140 people, both equipped with the latest technology and ideal for anything from conventions to fashion shows.



Michelangelo

ROMA

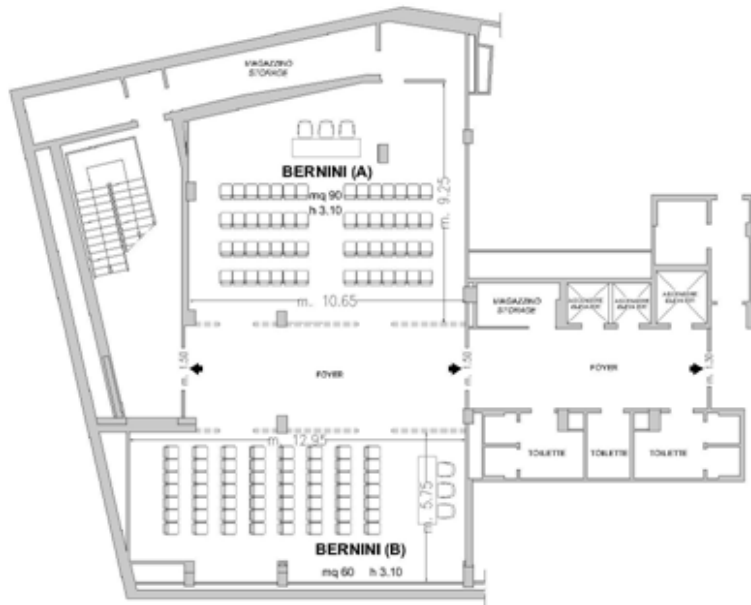

Piano -1 / Basement

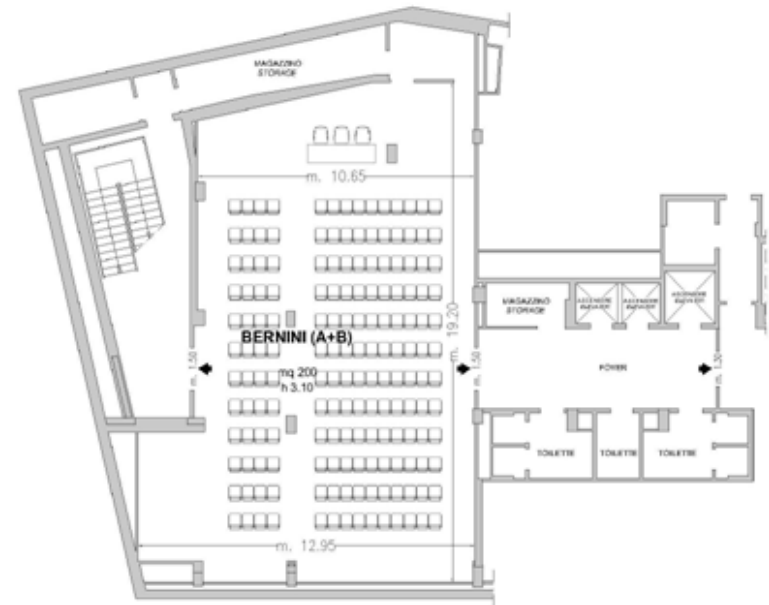

Piano -1 / Basement



Piano Terra / Ground Floor

- ◆ Uscite di sicurezza / Emergency Exits
- Finestre / Windows
- Pareti mobili / Modular Walls
- Colonne / Columns

Michelangelo

ROMA

Sale riunioni Meeting rooms	Area mq Area sq.ft.	Lung. x larg. mt. LxW ft.	Altezza mt. height ft.	Teatro theatre	banchi scuola class room	Tavolo unico ferro di cavallo conference table/U-shape	Cabaret style [^]	Cocktail reception	Banchetto banquet
Bernini (A)	90 968,4	10,56x8,50 34,64x27,87	3 9,83	60	27/30*	20	30***	50	60
Bernini (B)	60 645,6	12,84x4,95 42,11x16,23	3 9,83	55	20/25**	20	18***	40	40
Bernini (A+B)	200 2152	18,40x10,86 60,34x35,61	3 9,83	140	60	40****	54***	120	120
N° 6 Studio °	12 129,17	-	2,95 9,68	-	-	10	-	-	-
The Dome Restaurant °	270 2,906	25x7,85 81,99x25,74	2,90 9,51	-	-	-	-	140	140

° Luce Naturale / Daylight

* Max. 30, con 2 banchi uniti - 5 pax per fila - con 1 solo corridoio centrale / 2 connected tables - 5 pax for line - 1 central corridor

** Max. 25, con 2 banchi uniti - 5 pax per fila - no corridoio centrale / Max. 25, 2 connected tables - 5 pax for line - no central corridor

*** Cabaret Style con Tavoli diam. 180 cm. 6 pax per tavolo (c/videoproiezione) / Cabaret style, diameter tables cm 180, up to 6 pax each (c/videoprojection)

**** La videoproiezione è con schermo mobile sistemato verso gli armadi e con proiettore a terra / Videoprojection with movable screen, towards the armoirs, projector on floor